

Creating The Pinwheel Blocks

To create the pinwheel blocks, cut 2 1/4" strips (selvedge to selvedge) in the quantities below and trim off pieces as follows:

Bright Green: cut two strips and cut off 2 1/4" squares.

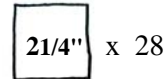

Grey: cut five strips and cut off squares and 4" pieces.

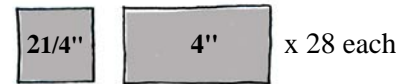

Turquoise: cut three strips and cut off 4" pieces.

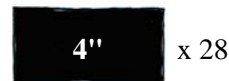

1. With right sides together, align a grey square face down at the top end of a turquoise rectangle.
2. Stitch diagonally from corner to corner as shown.
3. Trim as shown leaving a 1/4" seam allowance.
4. Fold grey fabric over at seam and iron.

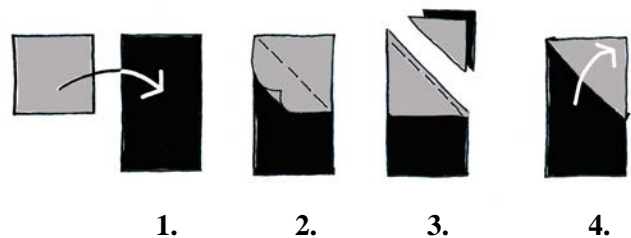

5. Align a green square face down at the bottom of this unit.
6. Stitch diagonally from corner to corner as shown.
7. Trim as before leaving a 1/4" seam allowance.
8. Fold green fabric over at seam and iron.

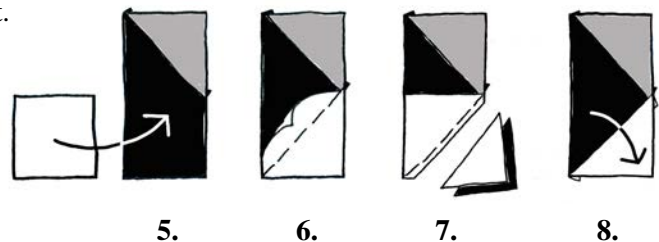

Create 28 of these units.

9. Join each unit to a grey rectangle as shown.

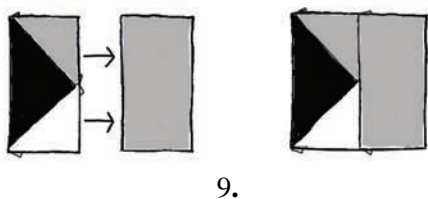

10. Sew four units together like this to create seven 7 1/2" blocks.

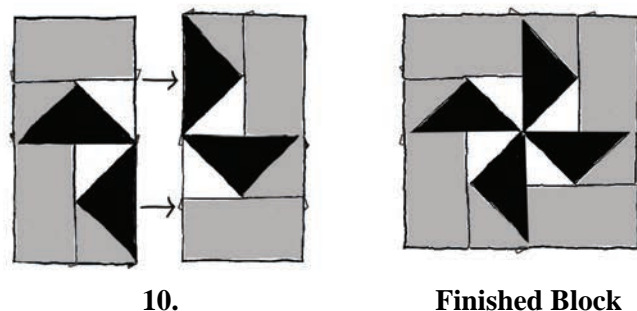

Finished Block